

Lubbock Area Economic Summary

Updated August 28, 2019

This summary presents a sampling of economic information for the area; supplemental data are provided for regions and the nation. Subjects include **unemployment, employment, wages, prices, spending, and benefits**. All data are not seasonally adjusted and some may be subject to revision. Area definitions may differ by subject. For more area summaries and geographic definitions, see www.bls.gov/regions/economic-summaries.htm.

Unemployment rates for the Lubbock area, selected area counties, and the nation

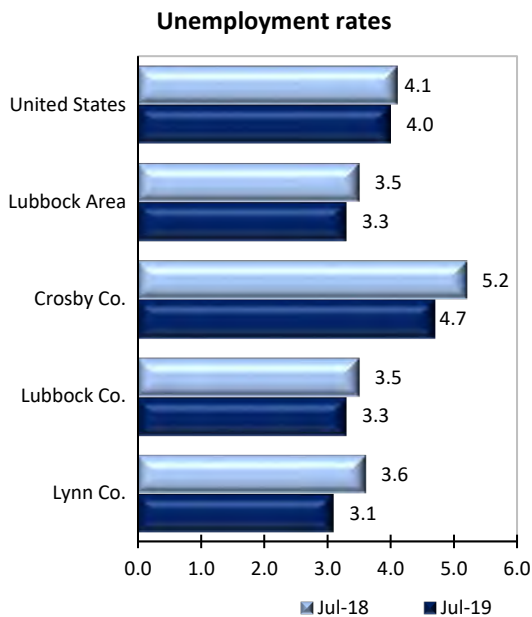

Source: U.S. BLS, Local Area Unemployment Statistics

Average weekly wages for all industries by county

Lubbock area, 4th quarter 2018
(U.S. = \$1,144; Area = \$885)

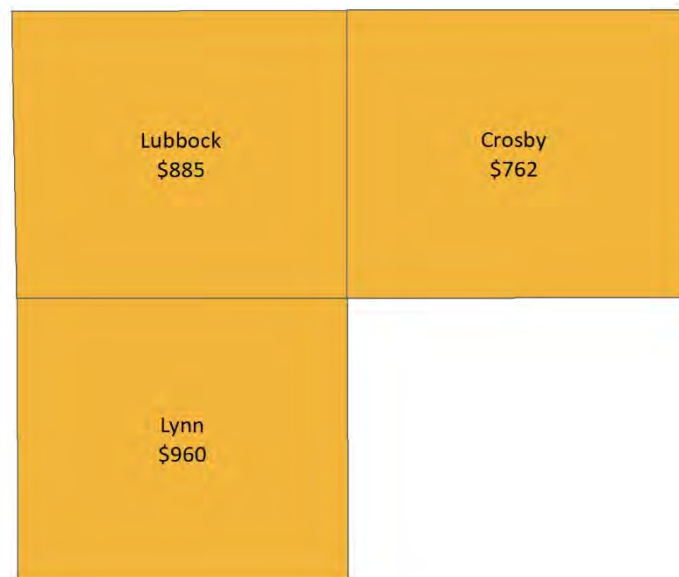

Source: U.S. BLS, Quarterly Census of Employment and Wages.

Over-the-year changes in employment on nonfarm payrolls and employment by major industry sector

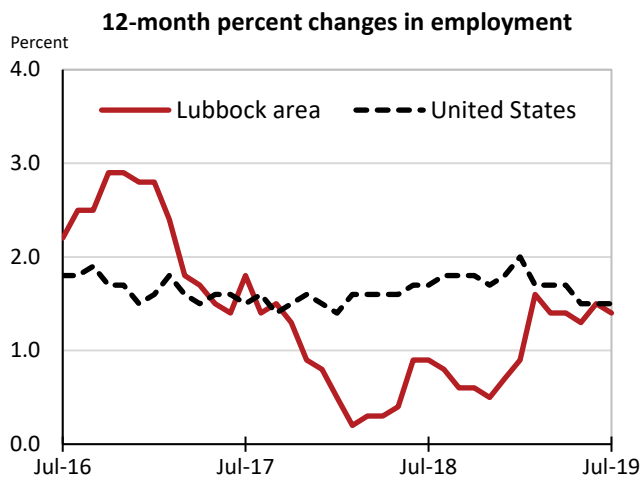

Source: U.S. BLS, Current Employment Statistics.

| Lubbock area employment (numbers in thousands) | Jul. 2019 | Change from Jul. 2018 to Jul. 2019 | |
|--|-----------|------------------------------------|---------|
| | | Number | Percent |
| Total nonfarm | 149.9 | 2.1 | 1.4 |
| Mining, logging, and construction | 9.1 | 0.4 | 4.6 |
| Manufacturing | 4.8 | 0.0 | 0.0 |
| Trade, transportation, and utilities | 31.6 | 0.8 | 2.6 |
| Information | 2.9 | 0.0 | 0.0 |
| Financial activities | 7.8 | 0.0 | 0.0 |
| Professional and business services | 12.7 | -0.2 | -1.6 |
| Education and health services | 20.9 | -0.4 | -1.9 |
| Leisure and hospitality | 20.5 | 0.5 | 2.5 |
| Other services | 6.2 | 0.2 | 3.3 |
| Government | 33.4 | 0.8 | 2.5 |

Source: U.S. BLS, Current Employment Statistics.

Over-the-year change in the prices paid by urban consumers for selected categories

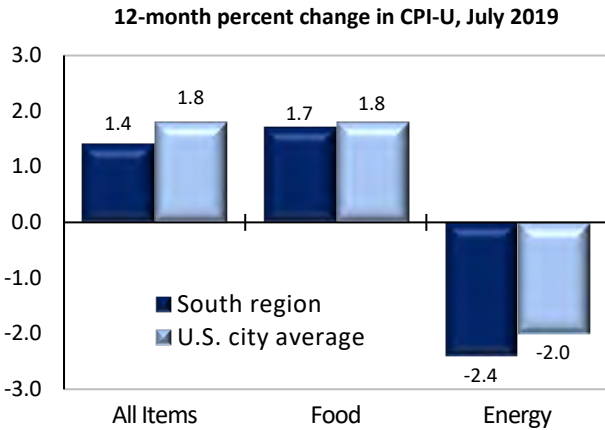

Source: U.S. BLS, Consumer Price Index.

Average annual spending and percent distribution for selected categories

South Region average annual expenditures 2017

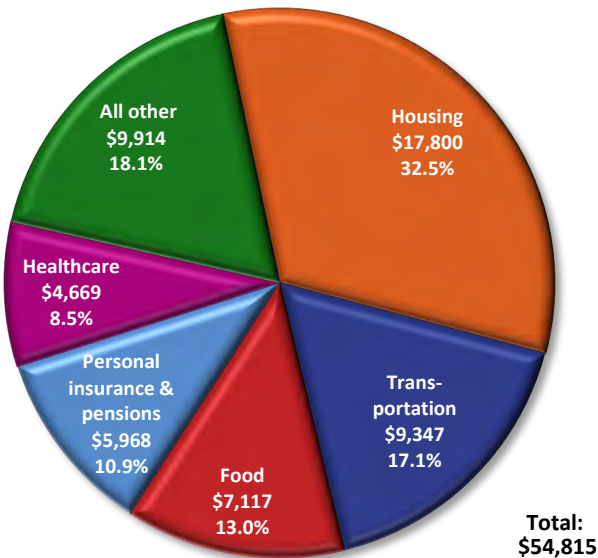

Source: U.S. BLS, Consumer Expenditure Survey.

Over-the-year changes in the selling prices received by producers for selected industries nationwide

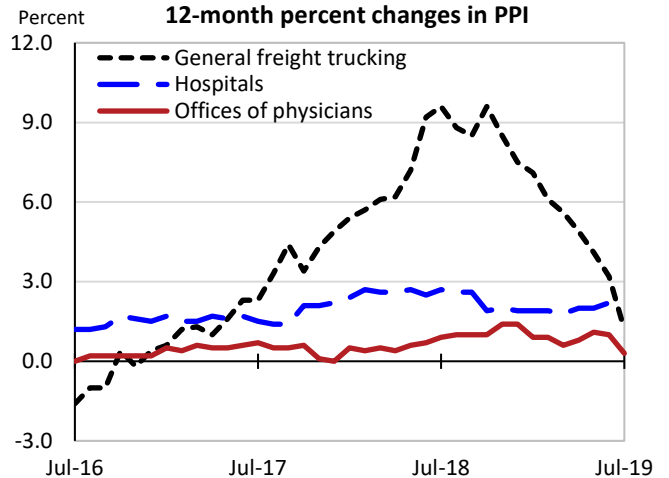

Source: U.S. BLS, Producer Price Index.

Average hourly wages for selected occupations

| Occupation | Lubbock area | United States |
|---|--------------|---------------|
| Total, all occupations | \$20.99 | \$24.98 |
| General and operations managers | 48.82 | 59.56 |
| Registered nurses | 33.84 | 36.30 |
| Accountants and auditors | 33.38 | 37.89 |
| Human resources specialists | 26.84 | 32.11 |
| Heavy and tractor-trailer truck drivers | 20.92 | 21.91 |
| Office clerks, general | 17.52 | 16.92 |
| Customer service representatives | 15.65 | 17.53 |
| Construction laborers | 15.20 | 19.40 |
| Retail salespersons | 13.45 | 13.61 |
| Stock clerks and order fillers | 12.09 | 13.71 |
| Cooks, fast food | 10.97 | 10.89 |
| Personal care aides | 9.11 | 12.06 |

Source: U.S. BLS, Occupational Employment Statistics, May 2018.

Employer costs per hour worked for wages and selected employee benefits by geographic division

| Private industry, March 2019 | West South Central (1) | United States |
|------------------------------|------------------------|---------------|
| Total compensation | \$32.01 | \$34.49 |
| Wages and salaries | 23.14 | 24.17 |
| Total benefits | 8.87 | 10.33 |
| Paid leave | 2.17 | 2.48 |
| Vacation | 1.08 | 1.28 |
| Supplemental pay | 1.16 | 1.10 |
| Insurance | 2.09 | 2.75 |
| Retirement and savings | 1.06 | 1.33 |
| Legally required benefits | 2.39 | 2.66 |

(1) West South Central includes AR, LA, OK, and TX.

Source: U.S. BLS, Employer Costs for Employee Compensation.

Over-the-year changes in wages and salaries

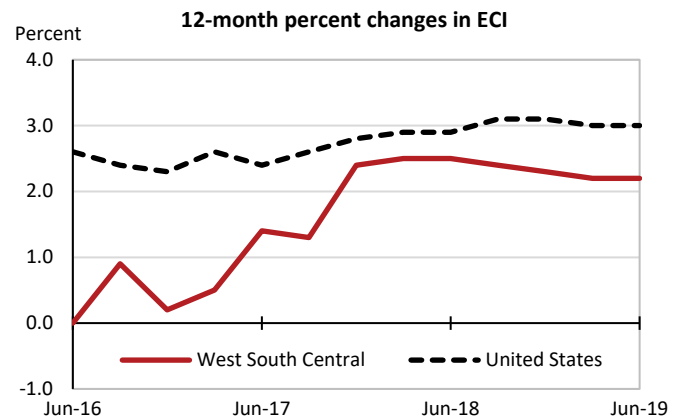

Source: U.S. BLS, Employment Cost Index.